

<i>Title:</i> AOS Protocol and Procedure: Reaeration Measuring Diffusion of O2 across the Water-Air Interface		<i>Date:</i> 04/23/2014
<i>NEON Doc. #:</i> NEON.DOC.000693	<i>Author:</i> K. Goodman	<i>Revision:</i> B

AOS PROTOCOL AND PROCEDURE: REAERATION MEASURING DIFFUSION OF O2 ACROSS THE WATER-AIR INTERFACE

PREPARED BY	ORGANIZATION	DATE
Keli Goodman	AQU	01/07/2011

APPROVALS	ORGANIZATION	APPROVAL DATE
Dave Tazik	SCI	04/14/2014
Mike Stewart	SE	04/21/2014

RELEASED BY	ORGANIZATION	RELEASE DATE
Stephen Craft	SE	04/23/2014

See configuration management system for approval history.

© 2014 NEON Inc. All rights reserved.

<i>Title:</i> AOS Protocol and Procedure: Reaeration Measuring Diffusion of O2 across the Water-Air Interface		<i>Date:</i> 04/23/2014
<i>NEON Doc. #:</i> NEON.DOC.000693	<i>Author:</i> K. Goodman	<i>Revision:</i> B

Change Record

REVISION	DATE	ECO #	DESCRIPTION OF CHANGE
A_DRAFT	10/31/2012	ECO-00680	Initial draft release
B	04/23/2014	ECO-01123	Initial production release

Title: AOS Protocol and Procedure: Reaeration Measuring Diffusion of O2 across the Water-Air Interface		Date: 04/23/2014
NEON Doc. #: NEON.DOC.000693	Author: K. Goodman	Revision: B

TABLE OF CONTENTS

1 DESCRIPTION.....1

1.1 Purpose 1

1.2 Scope..... 1

1.3 Acknowledgments..... 1

2 RELATED DOCUMENTS AND ACRONYMS1

2.1 Applicable Documents 1

2.2 Reference Documents..... 2

2.3 External References 2

2.4 Acronyms 2

2.5 Definitions..... 2

3 BACKGROUND AND OBJECTIVES3

3.1 Background 3

3.1.1 Assumptions..... 4

3.2 NEON Science Requirements 4

3.3 NEON Data Products 4

4 PROTOCOL4

5 QUALITY ASSURANCE AND CONTROL5

5.1 Decision Tree..... 6

5.2 Contingent Decisions 6

6 SAFETY7

7 PERSONNEL REQUIREMENTS.....7

8 TRAINING REQUIREMENTS.....7

9 FIELD STANDARD OPERATING PROCEDURE8

9.1 Sampling Frequency and Timing 8

9.1.1 Criteria for Determining Sampling Dates 8

9.1.2 Sampling Frequency..... 8

9.1.3 Sampling Timing Parameters 8

9.2 Equipment and Materials..... 9

9.3 Initial Trip 13

Title: AOS Protocol and Procedure: Reaeration Measuring Diffusion of O ₂ across the Water-Air Interface		Date: 04/23/2014
NEON Doc. #: NEON.DOC.000693	Author: K. Goodman	Revision: B

9.4	Outline of Major Steps on All Reaeration Days	14
9.5	Preparation	15
9.6	Sample Collection in the Field.....	19
9.7	Sample Preservation	26
9.8	Sample Shipping.....	26
9.9	Data Handling.....	27
9.10	Refreshing the Sampling Kit.....	27
9.11	Equipment Maintenance, Cleaning, and Storage	28
10	REFERENCES	28
APPENDIX A	FIELD DATA SHEETS	30
APPENDIX B	LAB DATA SHEETS.....	34
APPENDIX C	CONSIDERATIONS FOR IMPLEMENTATION	35

LIST OF TABLES AND FIGURES

Table 1.	Field equipment list: Initial trip.....	9
Table 2.	Field equipment list: Gas Injection	10
Table 3.	Field equipment list: Conservative Tracer Injection	11
Table 4.	Sampling.....	11
Table 5.	Field equipment list: Site-specific supplies	13
Table 6.	Field equipment list: Shipping equipment.....	13
Table 7.	List of sample ID numbers for the conservative tracer.....	18
Figure 1.	Fluid metering pump	16
Figure 2.	Example of injection calculation worksheet.....	17
Figure 3.	Schematic of stream reach with injection site and four downstream sampling stations.	19
Figure 4.	Field setup of the injection site with conservative tracer and inert gas	20
Figure 5.	Mounting of the pump on the conservative tracer bucket	21
Figure 6.	Gas tank, regulator, and flowmeter field setup.....	22
Figure 7.	Example of a syringe and stopcock in the "open" and "closed" positions	23
Figure 8.	A syringe with a 45 mL water sample	24
Figure 9.	A syringe with 45 mL of water and 15 mL of air	24
Figure 10.	Example of a syringe with a stopcock with attached needles.....	25
Figure 11.	Insertion of the needle into the gas vial through the rubber septum.....	25

Title: AOS Protocol and Procedure: Reaeration Measuring Diffusion of O2 across the Water-Air Interface		Date: 04/23/2014
NEON Doc. #: NEON.DOC.000693	Author: K. Goodman	Revision: B

1 DESCRIPTION

1.1 Purpose

The primary purpose of this document is to provide a change-controlled version of Observatory protocols and procedures. This document provides the content for training and field-based materials for NEON staff and contractors. Documentation of content changes (i.e. changes in particular tasks or safety practices) will occur via this change-controlled document, not through field manuals or training materials.

This document is a detailed description of the field data collection, relevant pre- and post-field tasks, and safety issues as they relate to this procedure and protocol.

1.2 Scope

This document relates the tasks for a specific field sampling or laboratory processing activity and directly associated activities and safety practices. This document does not describe:

- General safety practices
- Site-specific safety practices
- General equipment maintenance

It does identify procedure-specific safety hazards and associated safety requirements.

1.3 Acknowledgments

This protocol is based closely on the work by the Lotic Intersite Nitrogen eXperiment (LINX), the laboratories of Dr. Bob Hall, University of Wyoming, and Dr. Michelle Baker, Utah State University.

2 RELATED DOCUMENTS AND ACRONYMS

2.1 Applicable Documents

Applicable documents contain information that shall be applied in the current document. Examples are higher level requirements documents, standards, rules and regulations.

AD [01]	NEON.DOC.004300	EHS Safety Policy and Program Manual
AD [02]	NEON.DOC.004316	Operations Field Safety and Security Plan
AD [03]	NEON.DOC.000724	Domain Chemical Hygiene Plan and Biosafety Manual
AD [04]	NEON.DOC.001155	NEON Training Plan
AD [05]	NEON.DOC.050005	Field Operations Job Instruction Training Plan

Title: AOS Protocol and Procedure: Reaeration Measuring Diffusion of O2 across the Water-Air Interface		Date: 04/23/2014
NEON Doc. #: NEON.DOC.000693	Author: K. Goodman	Revision: B

2.2 Reference Documents

Reference documents contain information complementing, explaining, detailing, or otherwise supporting the information included in the current document.

RD [01]	NEON.DOC.000008	NEON Acronym List
RD [02]	NEON.DOC.000243	NEON Glossary of Terms
RD [03]	NEON.DOC.001152	NEON Aquatic Sample Strategy Document
RD [04]	NEON.DOC.005003	NEON Scientific Data Products Catalog
RD [05]	NEON.DOC.014051	Field Audit Plan; needs update to include Observation Systems audit
RD [06]	NEON.DOC.000824	Data and Data Product Quality Assurance and Control Plan
RD [07]	NEON.DOC.001085	Stream Discharge in Wadeable Streams
RD [08]	NEON.DOC.001646	NEON General AQU Field Metadata Sheet

2.3 External References

External references contain information pertinent to this document, but are not NEON configuration-controlled. Examples include manuals, brochures, technical notes, and external websites.

ER [01]	
ER [02]	
ER [03]	

2.4 Acronyms

Acronym	Meaning
ASR	Analytical Services Request
cm	centimeter
GC	Gas Chromatograph
HDPE	High-density polyethylene
ln	Natural Log
m	meter

2.5 Definitions

A **protocol** is a formal summary description of a procedure and its related rationale, and includes information on knowledge and resources needed to implement the procedure. A **procedure** is a set of prescribed actions that must take place to achieve a certain result, and can also be called a method. It differs from a science design in that science designs provide a more complete description of the rationale for selecting specific protocols. It differs from a training manual in that training manuals provide materials in support of skills acquisition in the topic areas including information on how to best train staff rather than detailing only the steps of the procedure.

Conservative tracer – a nonreactive chemical tracer that remains constant as it follows the flow of water. Ex) Chloride (Cl⁻)

Title: AOS Protocol and Procedure: Reaeration Measuring Diffusion of O ₂ across the Water-Air Interface		Date: 04/23/2014
NEON Doc. #: NEON.DOC.000693	Author: K. Goodman	Revision: B

Deaeration – loss of oxygen molecules from a liquid (or gas).

Diffusion – the movement of particles from an area of higher concentration to an area of lower concentration.

Discharge – the volume of water flowing past a point on a stream during a specified unit of time.

Ecosystem Metabolism – In streams, ecosystem metabolism is the measure of the production and respiration of organic matter. It is often used as a measure of stream function because it is a measure of the interaction between organic matter and nutrients across a stream reach.

Gas exchange rate – see reaeration rate.

Inert gas – a gas that does not interact with the environment thus making it a useful tracer of gas exchange across the air-water interface.

NaCl – Sodium Chloride (AKA salt). The Cl of the NaCl compound is the conservative tracer used in this protocol.

Plateau – Time at which the stream is at steady state with the conservative tracers (i.e. stream concentration remains constant)

Reaeration – Physical movement of gas from the atmosphere to a body of water.

Reaeration rate (AKA gas exchange rate) – the net rate at which gas exchanges across the air-water interface (i.e. gain and loss of oxygen).

SF₆ – Sulfur Hexafluoride. The inert (non-reactive) gas in this protocol.

Travel time – The length of time it would take an average grouping of water molecules to travel from one location within a watershed to another location.

3 BACKGROUND AND OBJECTIVES

3.1 Background

Stream metabolism measurements quantify the amount of primary production and respiration occurring within a reach (both benthic and water-column) by measuring changes in oxygen (O₂) concentration within a stream segment. Changes in oxygen concentration can occur from both biological, such as primary production (O₂ gain in the water column) and respiration (O₂ loss), and physical, such as gas exchange with the atmosphere (i.e., reaeration, the gain of O₂, or deaeration, the loss of O₂) as oxygen diffuses across the water-air interface. In order to understand the biological controls on oxygen within our systems, we must first account for the physical controls (e.g. reaeration or gas exchange).

Title: AOS Protocol and Procedure: Reaeration Measuring Diffusion of O ₂ across the Water-Air Interface		Date: 04/23/2014
NEON Doc. #: NEON.DOC.000693	Author: K. Goodman	Revision: B

Reaeration (i.e., gas exchange) is the movement of oxygen from the atmosphere into the water, and is measured as the net rate (i.e. gain and loss of oxygen) at which gas exchanges across the air-water interface. Stream reaeration rates are influenced by several physical characteristics of the site, such as the temperature, turbulence, wind, tributary and groundwater inputs, and oxygen concentration gradient across the interface. The reaeration rate coefficient (K_2) represents the combined effects of these physical characteristics. In turbulent and low productivity streams, reaeration rate coefficients may be the dominant term in the oxygen balance. Thus, it is imperative to quantify stream reaeration rates accurately as a small error in reaeration rates can dramatically skew stream metabolism results. Furthermore, reaeration represents the net flux of O₂ and CO₂ into and out of the atmosphere, and therefore accurately quantifying reaeration rates will be important for climate change research and carbon budget calculations.

3.1.1 Assumptions

- 1) Since we are unable to account for losses from our stream to groundwater, a critical assumption of reaeration measurements is that groundwater losses are minimal.
- 2) Assume tracers (both the inert gas and conservative tracer) are uniformly mixed in the channel cross section.

3.2 NEON Science Requirements

This protocol fulfills Observatory science requirements that reside in NEON’s Dynamic Object-Oriented Requirements System (DOORS). Copies of approved science requirements have been exported from DOORS and are available in NEON’s document repository, or upon request.

3.3 NEON Data Products

Execution of this protocol procures samples and/or generates raw data satisfying NEON Observatory scientific requirements. These data and samples are used to create NEON data products, which are documented in the NEON Scientific Data Products Catalog (RD[03]), available on the NEON website.

4 PROTOCOL

The field protocol used by NEON for measuring stream reaeration in small, wadeable streams follows the general requirements set forth by Lotic Intersite Nitrogen eXperiment (LINX) II (2004), the laboratories of Dr. Bob Hall, University of Wyoming, and Dr. Michelle Baker, Utah State University, as well as outlined in Hall and Tank (2003).

This protocol outlines the procedures required to measure gas exchange (i.e., reaeration rate coefficient, K_2) from the atmosphere to the water by use of an inert (i.e., will not interact with any biogeochemical processes) gas tracer (e.g., Sulfur Hexafluoride (SF₆), as well as a conservative tracer (e.g., NaCl) to account for groundwater inputs to the system. Stream reaeration is often measured by

Title: AOS Protocol and Procedure: Reaeration Measuring Diffusion of O ₂ across the Water-Air Interface		Date: 04/23/2014
NEON Doc. #: NEON.DOC.000693	Author: K. Goodman	Revision: B

injecting an inert gas (e.g., Propane or Sulfur Hexafluoride (SF₆)) into the stream water at the top of a study reach. Because the inert gas concentration is higher in the stream than the atmosphere, the gas diffuses out of the stream. The diffusion rate of the inert gas is proportional to the O₂ gas exchange rate (Wanninkhof 1992, Raymond et al. 2012). Thus, measurements of the concentration of the inert gas are used to calculate an O₂ reaeration (or deaeration) rate coefficients (K₂). To account for dilution due to surface or groundwater inputs, a conservative solute tracer such as chloride (Cl⁻) or bromide (Br⁻) is added to the stream in addition to the inert gas.

This protocol will only be implemented in small, wadeable streams. Reaeration measurements should be conducted when no other work is being conducted in the stream, as disturbance of sediments and habitat may influence reaeration results.

5 QUALITY ASSURANCE AND CONTROL

The procedures associated with this protocol will be audited according to the Field Audit Plan (RD[5]). Additional quality assurance will be performed on data collected via these procedures according to the NEON Data and Data Product Quality Assurance and Control Plan (RD[06]).

When unexpected field conditions require deviations from this protocol, the following field implementation guidance must be followed to ensure quality standards are met:

Samples should be processed (shaken, filtered, and transferred to appropriate containers) as soon as possible. If necessary, stream water may be collected in syringes, kept at 4°C, and processed within 4 hours at a base camp or Domain Lab (i.e., if weather dictates the need to leave the field immediately and stream discharge is increasing). Sample collection time, processing station and processing time must be recorded on the Reaeration Data Sheet.

If weather changes during the reaeration injection making conditions unsafe or if stream discharge increases such that the physical condition of the stream has changed, stop the injection and restart on the next scheduled bout.

Monitor the injection equipment during the injection to ensure proper functioning of the salt and gas injection equipment. If equipment malfunctions and can be fixed immediately, do so and continue the experiment, making note of the malfunction on the data sheet.

Title: AOS Protocol and Procedure: Reaeration Measuring Diffusion of O ₂ across the Water-Air Interface		Date: 04/23/2014
NEON Doc. #: NEON.DOC.000693	Author: K. Goodman	Revision: B

5.1 Decision Tree

- 1) Are the weather conditions safe for sampling (i.e. no lightning, hail or flooding)?
 - a) If YES, go to 2.
 - b) If NO, stop sampling.
- 2) Has there recently , within the past four hours, been any stream sampling that occurred within the reaeration reach?
 - a) If YES, go to 3.
 - b) If NO, continue sampling.
- 3) Did any of the previous work stir up sediments or add chemical constituents to the stream (i.e. salt additions)?
 - a) If Yes, allow stream to clear and disturbance to pass.
 - b) If NO, continue sampling.
- 4) Is the sampling location dry?
 - a) If Yes, resume work at a later date when stream is flowing.
 - b) If NO, continue sampling.
- 5) Is the stream flow great enough to ensure a travel time of <1.5 hours?
 - a) If Yes, continue sampling.
 - b) If NO, resume work at a later date when stream flow conditions are appropriate for protocol implementation.

5.2 Contingent Decisions

Reaeration measurements should not be conducted during or immediately after any fieldwork disrupting the stream bottom (i.e., morphology mapping, invertebrate collection, macrophytes collection, etc.). In streams with a shallow water column, samplers must be cautious not to stir up the benthic sediments when sampling the stream water. Disruption of the sediments by walking or by sampling too close to the stream bottom can contaminate your sample. Thus, always sample upstream from wading activity and minimize suspension of sediments when sampling. If sediments are disrupted, wait until the area has cleared before sampling.

The weather should be checked the day prior to the scheduled field sampling and adjusted to avoid any major storms. Should it begin raining during the reaeration injection enough to change the flow of the stream, stop the injection and restart at a later date. Reaeration measurements should not be made when the water level and discharge are changing rapidly. If the stream is exhibiting very low flow rates, is disconnected such that it is a series of pools not connected by surface water, or is dry, do not conduct an injection.

Make a note of any weather or stream conditions that could influence reaeration, including but not limited to wind, channel alterations, activities in the surrounding watershed, prior flood or rain events.

<i>Title:</i> AOS Protocol and Procedure: Reaeration Measuring Diffusion of O2 across the Water-Air Interface		<i>Date:</i> 04/23/2014
<i>NEON Doc. #:</i> NEON.DOC.000693	<i>Author:</i> K. Goodman	<i>Revision:</i> B

6 SAFETY

Personnel working at a NEON site must be compliant with safe field work practices as outlined in the Operations Field Safety and Security Plan (AD[02]) and EHS Safety Policy and Program Manual (AD[01]). Additional safety issues associated with this field procedure are outlined below. The Field Operations Manager and the Lead Field Technician have primary authority to stop work activities based on unsafe field conditions; however, all employees have the responsibility and right to stop their work in unsafe conditions.

Gas cylinders must be secured during transport (i.e., the regulator should not be attached to the tank, the safety cap should be screwed on and the tank should be secured during transport so as not to roll around, with the bottom of the tank pointed towards the floor). Never pick up a gas cylinder by the cap.

7 PERSONNEL REQUIREMENTS

Personnel are required to have working knowledge of gas tank handling and usage.

This protocol requires approximately 1 - 2 hours of pre-field work activities, such as tracer injection calculations, charging batteries, weighing salt, and labeling bottles. We estimate field sampling requires 2 technicians for 4 hours each sampling day plus travel to and from site. More time (additional 1-2 hours) may be needed in low flows.

8 TRAINING REQUIREMENTS

All technicians must complete required safety training as defined in the NEON Training Plan (RD[04]). Additionally technicians complete protocol specific training for safety and implementation of protocol as required in Field Operations Job Instruction Training Plan (RD[05]).

Personnel are to be trained in stream reaeration measurements and safe working practices for stream fieldwork. Refer to NEON Training Plan (RD [04]).

Title: AOS Protocol and Procedure: Reaeration Measuring Diffusion of O2 across the Water-Air Interface		Date: 04/23/2014
NEON Doc. #: NEON.DOC.000693	Author: K. Goodman	Revision: B

9 FIELD STANDARD OPERATING PROCEDURE

9.1 Sampling Frequency and Timing

Science Operations will provide sample timing annually.

9.1.1 Criteria for Determining Sampling Dates

Timing of sampling is site specific and determined by rules developed using historical (flow regime) and environmental data. For example, streams with little or no flow during the summer dry-season are sampled more intensively during wet periods. Streams with snowmelt-dominated hydrographs are sampled more intensively during spring/summer-elevated flows than during winter snow-covered months.

Following NEON site characterization, a relationship will be developed between reaeration and discharge. This relationship will be checked each year during Operations to ensure the curve has not shifted over time. To establish and maintain the reaeration-discharge rating curve, simultaneous measurements of reaeration and discharge must be made over a range of discharges. Therefore, the production of a continuous record of reaeration requires periodic manual reaeration measurement checks during Operations. In the event that the curve check does not produce results similar to the original reaeration-rating curve, such as after a major flooding or scouring event, a new curve will need to be established.

9.1.2 Sampling Frequency

Reaeration measurements shall be completed up to 6 times annually during NEON Operations in wadeable stream locations. NEON's target is to obtain 5 - 6 manual reaeration measurements per year during Operations.

9.1.3 Sampling Timing Parameters

In general, the reaeration curve will be checked for a high, low and average discharge event. Rating curve checks may also be completed during times selected to help fill in gaps in the measured data for the reaeration-discharge rating curve (i.e., when discharge is in a range with minimal or no reaeration measurements) in order to refine parts of the curve with little data. Stream discharge shall be measured on all reaeration measurement days RD[07].

Title: AOS Protocol and Procedure: Reaeration Measuring Diffusion of O ₂ across the Water-Air Interface		Date: 04/23/2014
NEON Doc. #: NEON.DOC.000693	Author: K. Goodman	Revision: B

9.2 Equipment and Materials

Table 1. Field equipment list: Initial trip

Maximo Item No.	Item Description	Quantity	Habitat-Specific	Special Handling
	5 gallon bucket/carboy (may need to be larger, depending on size of stream)	2		
	Conservative tracer: Chloride (Cl ⁻) or Bromide (Br ⁻)	1	Y	
MX100512	Conductivity probes, handheld, calibrated	2		
	Stopwatch	1		
	Neutrally buoyant object (i.e., orange)	1		
	Meter tape, 50 – 100 m metric	1		

Title: AOS Protocol and Procedure: Reaeration Measuring Diffusion of O ₂ across the Water-Air Interface		Date: 04/23/2014
NEON Doc. #: NEON.DOC.000693	Author: K. Goodman	Revision: B

Table 2. Field equipment list: Gas Injection

Maximo Item No.	Item Description	Quantity	Habitat-Specific	Special Handling
	Gas Tank (e.g., Sulfur Hexafluoride, SF ₆ or propane – site specific) 5-10 lbs (10 lb tank contains sufficient gas for about ~30 reaeration measurements)	1		
	Gas Tank Regulator	1		
MX100510	Gas Flowmeter:	1		
	- Gas flowmeter, able to regulate flow from 0 – 60 psi; variable area flow meter with needle valve tube with glass float; NPT threaded barbed fittings for tubing	1		
MX100551	- SS Tube Fitting, male, elbow 3/8 inch Tube OD, X 1/8 inch Male NPT	2		
	Gas-impermeable tubing: ¼ inch ID (inner diameter), (e.g., Tygon)	1		
	Teflon tape	1		
	1-1/8 inch wrench to connect regulator to SF ₆ tank	1		
	11/16 inch wrench tubing to gas flow regulator	1		
MX100905	Fine-pore diffuser (1 per stream SITE)	1		
	Small 125 mL squirt bottle of SNOOP (or soapy water) to test for gas leaks	1		
	Plastic Tote for safe transfer of equipment	1		
	Hook to hang gas flowmeter	1		

Title: AOS Protocol and Procedure: Reaeration Measuring Diffusion of O ₂ across the Water-Air Interface		Date: 04/23/2014
NEON Doc. #: NEON.DOC.000693	Author: K. Goodman	Revision: B

Table 3. Field equipment list: Conservative Tracer Injection

Maximo Item No.	Item Description	Quantity	Habitat-Specific	Special Handling
	5 gallon bucket/carboy (may need to be larger, depending on size of stream)	1		
	Extra bucket for filling conservative tracer reservoir	1		
	Conservative tracer: Chloride (Cl ⁻) or Bromide (Br ⁻) – Site Specific	1		
	4 L Jug	2		
MX103139 MX107105 MX103141	Fluid Metering (FMI) Pump – - QB metering pump, - Stainless Steel pump head with ceramic piston - Hose barb adapter (¼” Barb * ¼” MIP) - Feed-thru cord switch	1		
	Gel cell batteries (12 Volt)	2		
	¼ inch I.D. tubing – 10 and 1 foot long	2		
	Plastic 250 mL graduated cylinder	1		
	Stopwatch	1		
	12V Battery charger	1		
	Grease (high grade machine oil)	1		
	Plastic Tote for FMI pump	1		

Table 4. Sampling

Maximo Item No.	Item Description	Quantity	Habitat-Specific	Special Handling
	5 gallon bucket/carboy (may need to be larger, depending on size of stream)	1		
	Extra bucket for filling conservative tracer reservoir	1		
	5 Gallon bucket lid	1		
	Conservative tracer: Chloride (Cl ⁻) or Bromide (Br ⁻) – Site Specific	1		
HB07770000	Fluid Metering (FMI) Pump – - QB metering pump,	1		

Title: AOS Protocol and Procedure: Reaeration Measuring Diffusion of O2 across the Water-Air Interface		Date: 04/23/2014
NEON Doc. #: NEON.DOC.000693	Author: K. Goodman	Revision: B

Maximo Item No.	Item Description	Quantity	Habitat-Specific	Special Handling
	- Stainless Steel pump head with ceramic piston - Hose barb adapter (¼" Barb * ¼" MIP) - Feed-thru cord switch			
	Gel cell batteries (12 Volt)	2		
	¼ inch I.D. tubing – 10 and 1 foot long	2		
	Binder Clips	2		
	Plastic 250 mL graduated cylinder	1		
	Stopwatch	1		
	Battery charger	1		
	Grease (high grade machine oil)	1		
	Flagging, roll	1		
MX100512	Field thermometer and conductivity meter, handheld - calibrated	1		
MX102546	Logging Conductivity probes - calibrated	2		
MX102548	Logging Conductivity Probe shuttle	1		
	60-mL HDPE sample bottles (e.g., Nalgene), pre-labeled. Plus extras	25		
	60-mL syringes, with luer-lok tip, 1mL graduations (individually #ed and covered with clear packing tape to protect syringe labeling)	24		
	2-way male stopcocks, one per syringe	24		
	12 mL Exetainer gas vials with Double Wadded White Caps, pre-evacuated and pre-labeled	20		
	Gas vial rack	1		
	Labels for gas vials: 1 inch * 2-5/8 inches (e.g., Avery 5661)	20*		
	Silicone sealant, tube	1		
	Needles, 25 gauge, disposable 1 – 1.5 inches in length	20		
	25 mm/ 0.45 µm pore size syringe filters	25		
	"Sharps" container for needle disposal	1		
	Meter-tape, 50- metric field tape	1		
	Plastic Measuring Stick, folding	1		
	Discharge Equipment, see Measuring Discharge in Wadeable Streams Protocol (RD[07])			

- indicates you should take extra to field.

Title: AOS Protocol and Procedure: Reaeration Measuring Diffusion of O ₂ across the Water-Air Interface		Date: 04/23/2014
NEON Doc. #: NEON.DOC.000693	Author: K. Goodman	Revision: B

Table 5. Field equipment list: Site-specific supplies

Maximo Item No.	Item Description	Quantity	Habitat-Specific	Special Handling
	Infrastructure, such as stakes, rebar, or ring stand, for tracer injections	As needed		
	rope	As needed		
	Zip ties/Cable ties	As needed		
	Bridge/plank	As needed		
	Small cooler (~9 qt)	As needed		
	Ice or ice packs	As needed		
	Conductivity Standards	As needed		

Table 6. Field equipment list: Shipping equipment

Maximo Item No.	Item Description	Quantity	Habitat-Specific	Special Handling
	Lock and Lock box, ~ 2qt	1		
	Shipping cooler and boxes	1		
	Frozen ice packs for gas sample shipping	1		
	Field sheets, laboratory data sheets, pencils and sharpies	1		

9.3 Initial Trip

- 1) Locate Reaeration Reach, which is representative of the stream and has an injection site (i.e. the location at the top of the reach where we will add the SF₆ gas and NaCl solution) with a good mixing zone and minimizing the inclusion of large pools or dead zones (which increase travel time and water storage).
 - a) There will be 4 sampling stations within the reach, located downstream of the injection site (Figure 3).
 - i) The 1st sampling location (Station 1) should be just downstream of the distance it takes the conservative tracer to completely mix with the streamwater (25 - 100 m; higher flow streams often need more length to completely mix). During higher flows, mixing lengths may increase and injection sites may need to be moved upstream.
 - ii) The last sampling location (Station 4) will be located at the bottom of the reaeration reach.
- 2) Determine Reach Length:
 - a) The top of the reach must start with a good mixing zone to completely mix tracer with stream water. Best mixing zones are upstream of shallow pools with converging and diverging flows (Figure 4). This should allow for complete mixing before the first sampling location (Station 1), often occurring over a distance of 25 – 100 m. Wide, slow moving streams may have difficulties mixing. To ensure complete mixing at Station 1, during the continuous NaCl injection measure conductivity across main flowing section of the stream after steady state has been reached (i.e., the conductivity is no longer increasing). Depending on flows this could take 20 minutes to

Title: AOS Protocol and Procedure: Reaeration Measuring Diffusion of O ₂ across the Water-Air Interface		Date: 04/23/2014
NEON Doc. #: NEON.DOC.000693	Author: K. Goodman	Revision: B

several hours to attain. If the site is well mixed, conductivity should be similar across this main flow.

- b) Measure travel time between Station 1 and Station 4 - The best reach lengths are those that take ~40-45 minutes, during baseflow, for water to travel from Station 1 to Station 4. A simple way to estimate water travel time is to place an orange in the stream at Station 1 and follow the orange as it moves downstream for ~40-45 minutes to Station 4. Salt-pulse additions may be necessary to estimate travel time in small streams (<25-30 L/s), where travel time between Stations 1 and 4 is the difference in the timing of the salt profile half-height as it passes station 1 and 4. Adjust Station 4 upstream or downstream to obtain the appropriate travel time.

9.4 Outline of Major Steps on All Reaeration Days

- 1) Measure background conductivity and collect a background Cl⁻ sample at each of the four reaeration stations.
- 2) Measure discharge using the velocity-transect or salt-dilution method. See Wadeable Stream Discharge Protocol.
- 3) Continuous Injection of Gas (SF₆) and Salt (NaCl) – At the same time and location, add inert gas (to account for diffusion) and conservative tracer (to account for groundwater inputs) to the stream. Rate of addition depends on stream flow.
 - a) SF₆ Addition:
 - i) Streams with flows of 50-200 L/s (0.05 – 0.2 m³/s), receive approximately 100 mL/min.
 - ii) Most streams <1000 L/s (<1 m³/s) can also receive 100 mL/min. Increase gas flow rate, as necessary.
 - iii) In a bigger stream (>1000 L/s), increase gas flow to 200-300 ml/min.
 - b) Salt Addition:
 - i) 5-15-mg Cl⁻/L NaCl above background (10-30 μS/cm)
- 4) Collect Plateau Samples – While injection continues, take samples after the furthest downstream location (Station 4) reaches plateau of conservative tracer (NaCl).
 - a) Collect five 45-mL water samples at each of the 4 sampling stations into pre-labeled syringes – each syringe will provide a gas and water sample.
 - b) Record stream temperature, conductivity and time when samples are taken at each of the 4 sampling stations.
- 5) Process samples at a base camp away from stream and upstream of the injection site to limit potential SF₆ contamination.
- 6) Store samples appropriately.
 - a) Water samples → Tightly sealed in labeled 60-mL HDPE bottle.
 - b) Gas samples → Sealed in Gas Vials to be processed within 1 - 2 months.
- 7) Measure wetted widths at 30 evenly spaced locations along the stream reach (between Station 1 and Station 4).

Title: AOS Protocol and Procedure: Reaeration Measuring Diffusion of O ₂ across the Water-Air Interface		Date: 04/23/2014
NEON Doc. #: NEON.DOC.000693	Author: K. Goodman	Revision: B

9.5 Preparation

The day before:

- 1) Assemble and test pump before going to field.
 - a) If piston has been withdrawn more than 2 inches from the cylinder (Figure 1a), or removed completely from the pump head (Figure 1b), you **MUST** take special precautions before reassembling pump or **Lip Seals will be damaged**.
 - i. Remove Gland Nut and install Lip Seals one at a time (Figure 1b), and ensure you do not damage the seal or the 'lips' (See Section 18 Piston Seal Replacement in FMI pump manual for more detail). Note, top Lip Seal should have 'lip' facing up while bottom Lip Seal should have 'lip' facing down.
 - b) Add a small drop of grease (high grade machine oil) to the drive pin head (Figure 1a) just before it is inserted into the radial bearing.
 - c) Insert piston drive pin into the radial bearing in the spindle assembly (Figure 1c). You can pull the piston out ~1 inch to make the insertion easier. Do not pull the pin out more than 2 inches.
 - d) At the same time as you insert the drive pin into the bearing, slide the drive carrier into the pump base assembly (Figure 1b), which will slide the ceramic piston completely into the cylinder. **IMPORTANT:** As you slide the drive carrier into the assembly, you must ensure that the knob on the underside of the drive carrier slides into the plastic slide (Figure 1a) at the same time.
 - e) Using the adjustment knob and the calibration scale, adjust rate to achieve the desired flow rate. If the carrier does not move when adjustment knob is turned, the knob is not properly attached to the plastic slide.
 - i. The angle of the cylinder with respect to zero (center) on the calibration scale controls the magnitude and direction of flow. Ex) If cylinder is pointed to left at 10 on the scale, the fluid will be passed from the right port to the left port at 100% of the maximum rated volume. If the cylinder is pointed to the 5 on the right calibration scale, the fluid will be passed from the left to the right port at 50% of the maximum flow rate.
 - ii. Minimum Pump rates are 10% of the maximum rated flow rate.

NOTE: The majority of NEON maximum pump flow rates will be 1296 ml/min (Q2 piston code). Minimum pump rate for this pump is 129.6 ml/min. A Q1 piston code maximum pump rate is 576 ml/min.
 - f) Tighten thumbscrew (Figure 1a) to hold drive carrier in place.
 - g) If you need to adjust flow rate, loosen the two thumbscrews slightly and use the adjustment knob as necessary. You can change the flow rate while the pump is still pumping. Remember that the pump flow rates are very sensitive, thus small adjustments may be all that is required. Retighten thumbscrews when adjustment is complete.

Title: AOS Protocol and Procedure: Reaeration Measuring Diffusion of O2 across the Water-Air Interface		Date: 04/23/2014
NEON Doc. #: NEON.DOC.000693	Author: K. Goodman	Revision: B

a)

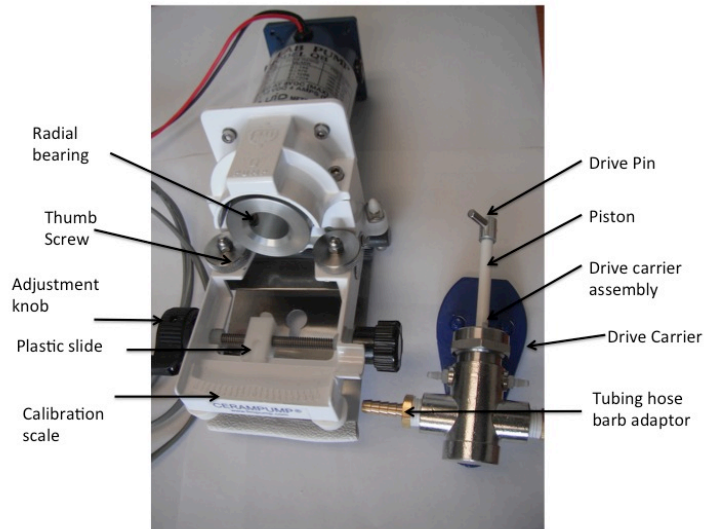

b)

Pump Head Materials Configuration

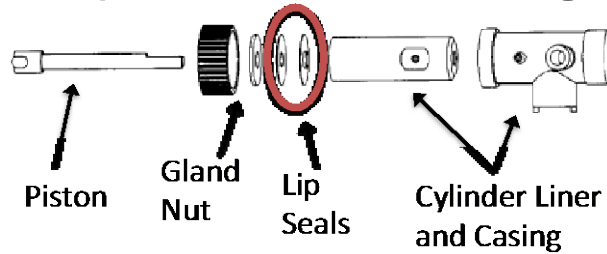

c)



Figure 1. Fluid metering pump a) Components of pump drive (left) and pump head (right), b) Configuration of pump head (modified from fluidmetering.com/materials-construction.html), and c) Assembly of pump head into pump drive

Title: AOS Protocol and Procedure: Reaeration Measuring Diffusion of O2 across the Water-Air Interface		Date: 04/23/2014
NEON Doc. #: NEON.DOC.000693	Author: K. Goodman	Revision: B

- b) Test Pump: Test pump by placing it on the rim of a 5-gallon bucket with inlet and outlet tubing ends placed in the bucket containing tap water. Connect the pump to a battery and run the pump to make sure everything is connected and working properly. Look for leaks.
- c) Use the injection calculation spreadsheet (Figure 2) to calculate the quantity of the conservative tracer (NaCl) you will need to add to the bucket/carboy. Tracer addition needs to be large enough to detect the tracer at the most downstream sampling station and will vary by location and time as discharge and background conductivity values change. Aim for a 5-15 mg/L increase in Cl⁻, with <50% saturation of the conservative tracer. The calculation spreadsheet (Figure 2) will be provided by NEON.

Injection Specs: Chloride Calcs			
Injection #	1		
Site:	Red Butte		
Inj Date:			
Chloride: Calculations for solute concentrations			
			= adjust as necessary
Injection Variables			
Chloride (Cl) enrichment target (mg/L)	adjust-->	7.00 mg/L	
Release rate (mL/min)		200.00 mL/min	3.168 gph 200.00 ccm/min
Volume of release solution (L)		17.00 L	4.4914 gallons Size of tank needed.
Estimated stream Q (L/s)		60.00 L/s	
Injection time (h)		1.00 h	
Pump parameters			
Max pump rate (mL/min) for given res. vol. and injection time		283.33 mL/min	
Max injection time (h) for given res. vol. and release rate		1.4167 h	
Chloride parameters			
Desired Cl conc. in release solution (g Cl/L)		126 g Cl/L	
Amount of NaCl (g) to add to carboy		3531 g	7.7844 lb Amount of salt needed.
Resultant Cl concentration in carboy (mg Cl/L)		126000 mg Cl/L	3531 g
% saturation of NaCl		58.1804 %	75% max <50% sat is safer

Figure 2. Example of injection calculation worksheet

- d) The amount of salt required is a product of the target enrichment, the estimated stream flow and the injection rate. Use current pressure transducer data and discharge rating curve, if available.

$$\begin{aligned}
 \text{Amt of NaCl (g)} &= (((\text{Cl}^- \text{ target enrichment (mg/L)} * \text{Stream Q (L/s)} \\
 &* 60)/(\text{injection rate (mL/min)}) * 58.44247/35.4527) \\
 &* \text{Volume of Tracer Solution (L)}
 \end{aligned}$$

- e) Weigh out the amount calculated and dissolve the salt in tap water in a small container, as needed (i.e., a liter bottle or a 4-L jug). Ensure the tracer is completely dissolved.
- f) **Record** the amount of salt added on the Injection Field Data Sheet (See Appendix A, Field Data Sheets).
- g) Confirm that you have newly evacuated gas vials from a gas laboratory.

Title: AOS Protocol and Procedure: Reaeration Measuring Diffusion of O2 across the Water-Air Interface		Date: 04/23/2014
NEON Doc. #: NEON.DOC.000693	Author: K. Goodman	Revision: B

- h) Charge two gel-cell batteries OVERNIGHT.
- i) Calibrate the conductivity meter and probes and check their battery life. Set probes to begin logging on the reaeration field day. Note: Probes should be logging prior to placing them in the stream. See user manual for calibration and usage instructions.
- j) Label all gas vials and conservative tracer bottles (60 mL HDPE).
 - a) Gas: Label the gas vials with Site IDs (4 or 7 letter identifier code), date (YYYYMMDD), and syringe number (1-20).
 - b) Conservative Tracer: Label 25 sixty (60) mL plastic bottles. Mark Site ID, StationID, Sample ID (Table 7), date (YYYYMMDD) and time (24:00) on the bottle label. Site ID_ Sample ID (Ex. Red Butte Creek, Station 4, Sample 16 would be REDB_16.). Sample IDs are: BS1-S4 – Background Station 1 – Station 4, 0- Injectate, 1-5 indicates the five samples taken at Station 1, 6-10 indicates the five samples taken at Station 2, 11-15 samples at Station 3, 16-20 samples at Station 4 (Table 7). The bottle sample IDs correspond to the field syringe IDs.

Table 7. List of sample ID numbers for the conservative tracer

Sample Station	Sample ID
Background	B Station # (S1 – S4, where S1 is Station 1).
Injectate	0
Station 1	1-5
Station 2	6-10
Station 3	11-15
Station 4	16-20

Note: The injectate sample bottle is SampleID #0. The SampleID number corresponds to the syringe number.

Title: AOS Protocol and Procedure: Reaeration Measuring Diffusion of O ₂ across the Water-Air Interface		Date: 04/23/2014
NEON Doc. #: NEON.DOC.000693	Author: K. Goodman	Revision: B

9.6 Sample Collection in the Field

- 1) In the field, fill out the General AQU Field Metadata Sheet (RD [08]) before collecting samples.
- 2) Background Sampling
 - a) First, visit each of the four sampling stations (Figure 3), and at each station record four conductivity measurements from the stream thalweg (i.e. the main flow of the stream), for a total of 16 conductivity measurements (See Appendix A, Field Data Sheets). Make sure the hand-held conductivity meter is set on the temperature-corrected setting (the ‘°C’ should be flashing). If the setting is not correct, press the mode button until you enter the temperature-corrected mode. Wait for the meter to adjust to the stream temperature for more accurate conductivity measurements.

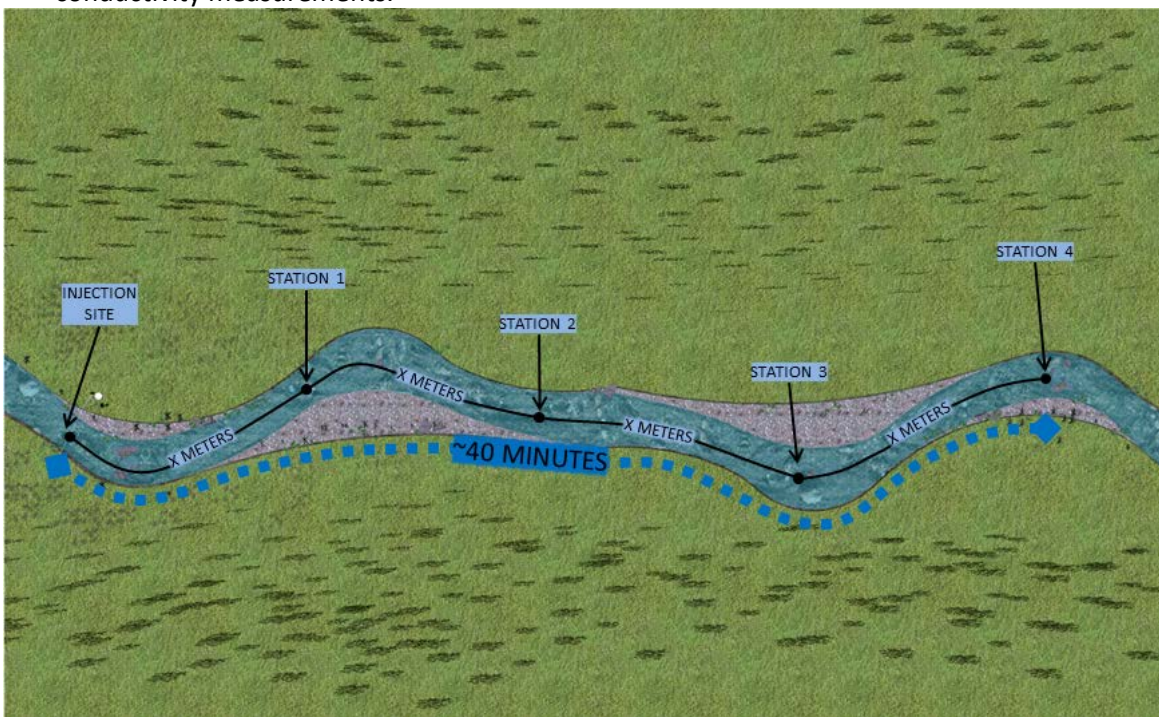

Figure 3. Schematic of stream reach with injection site and four downstream sampling stations. Travel time between Station 1 and 4 should be ~40 minutes.

- b) At each location, collect 60 mLs of stream water from the thalweg using the corresponding background syringes. Using a syringe filter, rinse and filter the sample into a 60 mL bottle for a background Cl⁻ sample. Label as Site ID, B (background), Station # (S1 – S4, where S1 is Station 1).
 - c) Mark and label each location with flagging tape, if necessary, to help find the sampling locations during the injection
 - d) Place logging conductivity probes in the thalweg at Station 1 and Station 4. Probes should already be logging.
- 3) In Field (plan 3-4 hours)
 - a) Fill a 5-gallon bucket/carboy with stream water and stir in the prepared concentrated salt solution. This will allow some time for the water to warm while you get the rest of the set-up ready and will allow any undissolved salt to dissolve more easily. You may need to increase the

Title: AOS Protocol and Procedure: Reaeration Measuring Diffusion of O ₂ across the Water-Air Interface		Date: 04/23/2014
NEON Doc. #: NEON.DOC.000693	Author: K. Goodman	Revision: B

- size of your bucket if the stream is large or flows are very high. **Record** the volume of the bucket/carboy on the injection data sheet (Appendix A).
- b) Set up the bucket/carboy, tubing, battery, and pump on a level surface at the injection site (Figure 4). If a level surface on the bank is not adequate, place pump set-up on a bridge or plank laid across the stream.

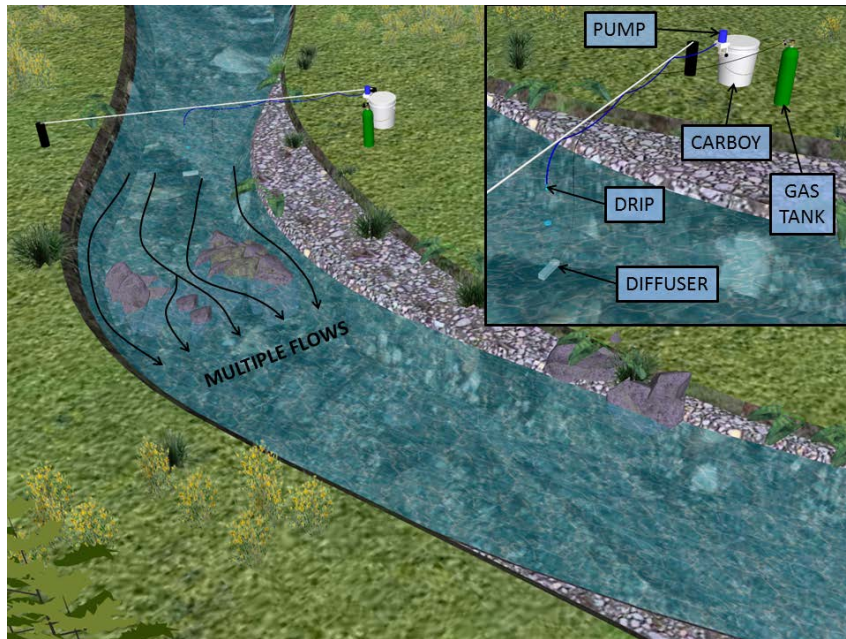

Figure 4. Field setup of the injection site with conservative tracer and inert gas

- c) Pump setup:
- i) Mount pump upright for best performance. Pump can easily be mounted on the wall of a 5-gallon bucket (Figure 5).
 - ii) Place the pump inlet tube into the container with the saltwater solution. Ensure the end of the tubing remains in the solution (e.g., weight the end of the tube or use a binder clip to secure the tube to the side of the 5-gallon bucket so that the tubing end remains in the solution). The end of the tube should be near the bottom of the bucket so that as the tracer level draws down throughout the injection, the tubing will remain in the solution. Pumping air through the pump will damage it.
 - iii) Attach the pump electrical wires to the battery (Red to Red and Black to Black).

Title: AOS Protocol and Procedure: Reaeration Measuring Diffusion of O ₂ across the Water-Air Interface		Date: 04/23/2014
NEON Doc. #: NEON.DOC.000693	Author: K. Goodman	Revision: B



Figure 5. Mounting of the pump on the conservative tracer bucket

- d) Pump Calibration: Allow the pump to run, with the end of the outlet tube feeding back into the bucket/carboy for several minutes to allow for the tubing to fill with the injection solution. Calibrate the pump using a stopwatch and graduated cylinder to the desired pump rate from the injection spreadsheet (Figure 2). To ensure a more accurate calibration, make sure to test the injection at the same height that the tubing will be placed during the injection.
- i) NOTE: This step may take several minutes, but it is extremely important to get the correct pump rate.
 - ii) Every time you test the rate, pour the injectate back into the bucket/carboy and return the outlet tubing to the pump. DO NOT dispose of injectate solution.
 - iii) Record the actual (what was measured in the cylinder) pump rate on the data sheet as "Start Pump Rate" (See Appendix A, Field Data Sheets).
- e) Pump Set-up: The end of the tubing should be placed a few inches above the water surface. **DO NOT** put the tubing in the stream because it will change the pump rate. Attach the tubing to something stable, such as a piece of rebar pounded into the streambed or a tree above the stream. Make sure to INJECT (i.e., Drip) INTO THE THALWEG so the solution will mix as quickly as possible with the stream water (Figure 4).
- f) Collect a 60 mL bottle of conservative tracer injection solution into the bottle labeled with 'SampleID 0'. This is an **EXTREMELY IMPORTANT** step so that we know the exact concentration of the solution we added to the stream.
- g) **Gas Injection Set-up:**
- i) At the injection site, set-up the SF₆ gas tank, regulator and flow meter (Figure 6).
 - (1) Attach the regulator to the gas tank using the appropriate size wrench (1-1/8 inch wrench).
 - (2) Use gas-impermeable (e.g., Tygon) tubing to connect the SF₆ gas tank and regulator to the gas flow meter. Make sure that the tube running from the gas tank is connected to the BOTTOM connector of the flowmeter.

Title: AOS Protocol and Procedure: Reaeration Measuring Diffusion of O ₂ across the Water-Air Interface		Date: 04/23/2014
NEON Doc. #: NEON.DOC.000693	Author: K. Goodman	Revision: B

- (3) Use gas-impermeable (e.g., Tygon) tubing to connect the TOP of the flowmeter to the diffuser (air stone). The tank can lie on the ground.
- (4) Make sure diffuser remains underwater and is at the same location in the stream as the conservative tracer injection (Figure 4).
- (5) Ensure the flowmeter is vertical. The flowmeter must remain upright for the best performance.

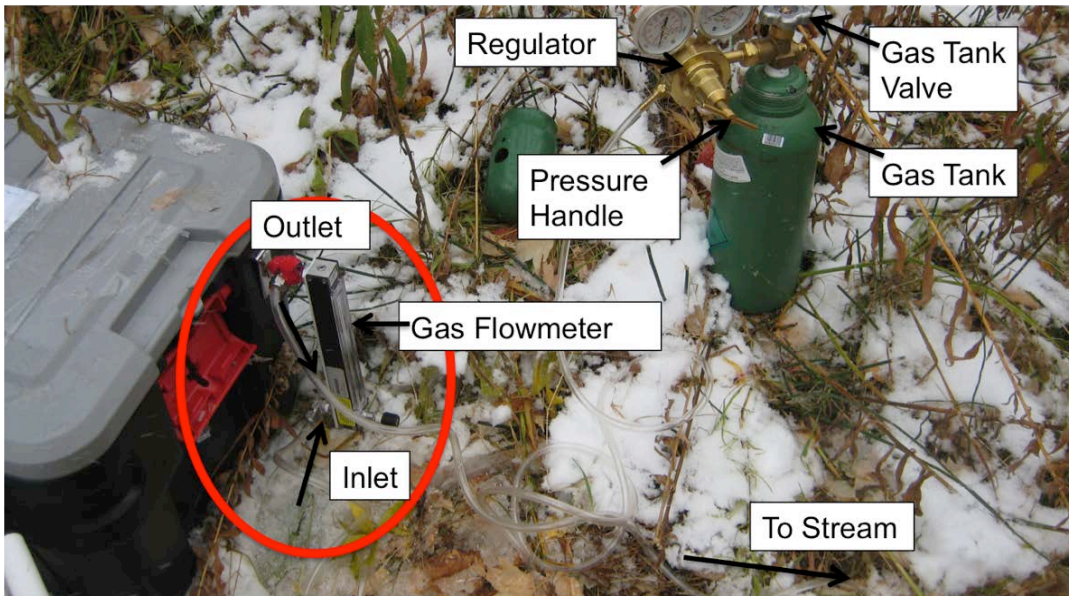

Figure 6. Gas tank, regulator, and flowmeter field setup

- (6) Connect all parts of the gas set-up before opening the main value on the tank.
 - (7) Turn regulator pressure handle completely to the right on the regulator. This will close the regulator valve and keep your gas from blowing through before you are ready.
 - (8) Open the gas tank valve.
 - (9) Slowly turn the regulator pressure handle to the left to allow gas to flow to the flowmeter.
 - (10) Set the regulator at 12 psi.
 - (11) On the flowmeter, turn the valve so that it reads approximately 35 psi. If stream flows are low, you will need to increase the gas pressure to ensure enough gas makes it to the downstream sampling stations. Make sure you see little bubbles coming out of the diffuser (air stone).
- h) Start the pump for the salt injection at the **same time** as the gas injection.
 - i) Note the start time on the Reaeration Field Data Sheet (Appendix A).
 - j) Spend a few more minutes at the injection site making sure the salt and gas injections are working properly.
 - k) Next, walk to the MOST DOWNSTREAM location (with your travel time in mind, make sure you arrive in time to take rising limb conductivity readings). You will need a hand-held conductivity meter.
 - l) Once at the most downstream station, place the handheld conductivity meter in the stream. Make sure the probe is fully submerged in the main flow. Do not put the probe in a side pool.

Title: AOS Protocol and Procedure: Reaeration Measuring Diffusion of O ₂ across the Water-Air Interface		Date: 04/23/2014
NEON Doc. #: NEON.DOC.000693	Author: K. Goodman	Revision: B

- m) Continue to observe conductivity until the stream has reached plateau (when salt concentration/conductivity measurement is no longer rising). Sampling should not begin until the stream has reached plateau at the MOST DOWNSTREAM location, usually 45 minutes to an hour during low flows and will be faster during high flows.
- n) Once the most DOWNSTREAM location has reached plateau, start sampling at the most UPSTREAM location (i.e., Station 1, the station closest to the injection site) and work downstream (Figure 3). The idea is that you are following a parcel of water as it moves downstream.
- o) At Station 1, record 5 temperature-corrected conductivity measurements across the main flowing section of the stream. You only need to do this step at Station 1 to ensure tracer is mixed across the stream (See Appendix A, Field Data Sheets).
- p) Take 5 syringe samples in the thalweg at each sampling stations. You may need to get into the stream to do this. Only step into the stream at designated sampling locations and do your best to not disturb the sediment as you walk. If you do kick up benthic sediments, wait for the area to clear before sampling. ALWAYS take samples upstream of where you are standing.
- q) RINSE: Place the syringe tip (with 2-way stopper attached and turned to open; Figure 7) into the stream so that you are sampling the water ~10 cm under the surface of the water. Pull in ~20 mL water and remove syringe from stream. Rinse the syringe by pulling the stopper all the way back (without removing it) and shake. Expel the rinse water downstream or onto the bank. Repeat.

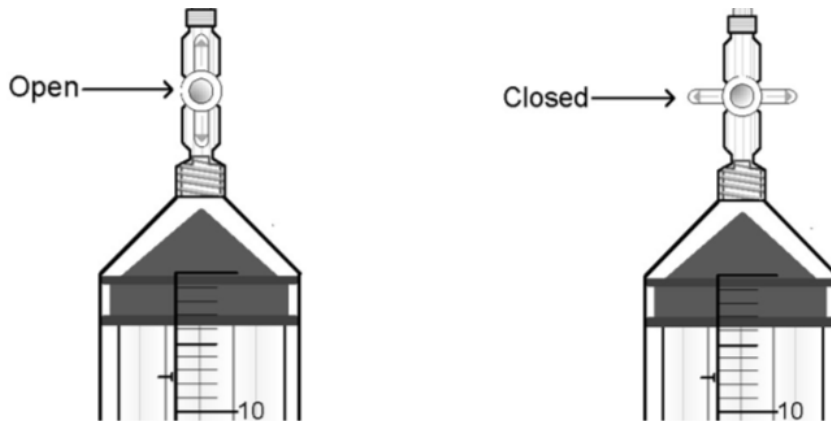

Figure 7. Example of a syringe and stopcock in the "open" and "closed" positions

- r) **SAMPLE:** Put the syringe tip back into the water, below the surface, and pull the plunger until the syringe is completely full. Remove the syringe and tap the sides of the syringe firmly with your hand/fingers to remove the air bubbles. EXPEL water, leaving approximately 1 mL in the syringe, which will help reduce air intake on the next sampling. Put the syringe back in the water, expel the final 1 mL of aerated water below the stream surface, and slowly fill to the 45 mL mark, being careful not to entrain any air bubbles (Figure 8). Immediately turn the 2-way stopper to the closed position before removing the syringe from the stream (Figure 7). Take 5 separate syringe samples all within the main flow of water. Place the syringe in a small cooler to help maintain stream temperature at time of collection.

Title: AOS Protocol and Procedure: Reaeration Measuring Diffusion of O ₂ across the Water-Air Interface		Date: 04/23/2014
NEON Doc. #: NEON.DOC.000693	Author: K. Goodman	Revision: B

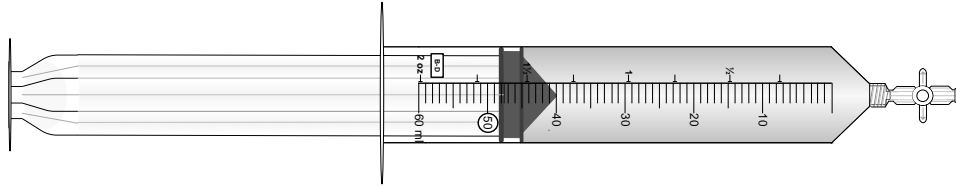

Figure 8. A syringe with a 45 mL water sample

- s) At each station, note the time, 5 syringe IDs, water temperature, and conductivity on the reaeration spreadsheet (See Appendix A, Field Data Sheets).
 - t) REPEAT (steps u-x) for each sampling station, always working from upstream to downstream. When walking between stations, do not walk in the stream.
 - u) Return to the Injection Site. Test and Record the 'End Pump Rate' and time on the field data collection sheet (See Appendix A, Field Data Sheets).
 - v) END INJECTION: Turn off Gas and Pump.
 - w) If you did not already, SAVE some conservative tracer solution in a 60 mL bottle, labeled with station number (DXX), stream name, Sample ID 0, and date (YYYYMMDD).
 - x) RINSE Cl⁻ INJECTION EQUIPMENT:
 - i) Return any remaining conservative tracer solution to the plastic jugs used to transport the concentrated solution to the field. The salt solution will need to be disposed of in the lab, so as not to add too much salt to the stream.
 - ii) Fill the bucket/carboy with fresh stream water and run the pump for 30 minutes to flush the NaCl from the pump equipment.
 - y) COLLECT logging conductivity meters.
 - z) BREAK DOWN the gas and NaCl injection set-ups.
- 4) Sample Processing
- a) Away from stream, where there will be no contamination in the air from the injection, such as upstream and upwind, open stopcock and draw in 15 mL of air so the syringe is filled to the 60 mL mark with air and water (Figure 8). Close stopcock. VERY IMPORTANT: To be consistent, be sure to have the bottom of the meniscus at the 15 mL mark (Figure 9).

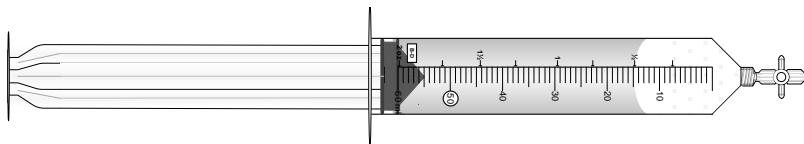

Figure 9. A syringe with 45 mL of water and 15 mL of air

- b) SHAKE: Once samples have been collected from ALL locations, shake each syringe for 5 minutes to equilibrate the air and SF₆. To save time, shake multiple syringes at once.
- c) SAMPLE GAS: Label the gas vials with Site ID (4 or 7 Letter Code), date (YYYYMMDD), Station #, and syringe number.
- d) After shaking, place needle with needle cover still attached on 2-way stopcock. Once needle is attached, remove the plastic covering. Holding the syringe upright, open the stopcock (Figure 9) and push a small amount of air (~0.5 mLs) through the needle to purge the air in needle.

Title: AOS Protocol and Procedure: Reaeration Measuring Diffusion of O ₂ across the Water-Air Interface		Date: 04/23/2014
NEON Doc. #: NEON.DOC.000693	Author: K. Goodman	Revision: B

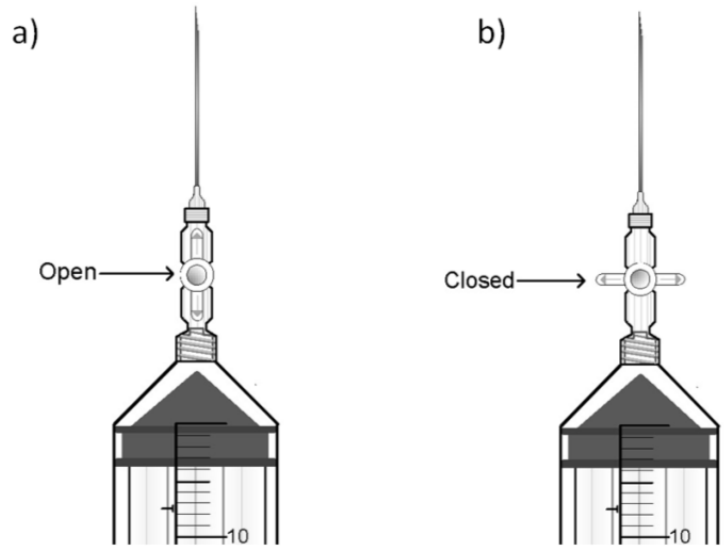

Figure 10. Example of a syringe with a stopcock with attached needles in the a) "open" and b) "closed" positions

- e) With stopcock still 'open' and syringe held upright, insert the needle through the rubber septum of the gas vial (Figure 10 and Figure 11) and push gas into the vial. Properly evacuated vials will automatically suck in the gas. Push as much gas in as possible.
- f) Make sure to OVER-PRESSURIZE THE VIALS to prevent gas from leaking into the vials (you can normally get ~13 mLs of air into the septum). Pull the syringe needle out quickly without closing the 2-way stopper. This makes loss of gas less likely.
- g) Discard needle in a Sharps container with a lid.



Figure 11. Insertion of the needle into the gas vial through the rubber septum

Title: AOS Protocol and Procedure: Reaeration Measuring Diffusion of O ₂ across the Water-Air Interface		Date: 04/23/2014
NEON Doc. #: NEON.DOC.000693	Author: K. Goodman	Revision: B

- h) **SAMPLE CONSERVATIVE TRACER:** Remove the 2-way stopcock. Hold syringe upright and expel remaining air from the syringe (Pushing air through the filter can cause the filter to rupture). Attach a 25 mm/ 0.45 µm filter capsule onto the syringe. Rinse the 60 mL bottle with 5 mLs of filtered sample twice. Filter the remaining syringe sample (~35 mLs) into the bottle. Be sure the bottle is labeled with station number (DXX), stream ID, date (YYYYMMDD), and syringe number. Repeat for all syringes.
 - i) DISCARD filter and replace stopcock on each syringe.
 - j) Additional data to collect: 30 stream wetted width measurements evenly spaced throughout the reach, between Station 1 and Station 4 (e.g. 10 wetted width measurements between station 1 and 2, 10 measurements between station 2 and 3 and 10 measurements between station 3 and 4) completed at the end of each injection.
- 5) Troubleshooting
- a) Diffuser: If no bubbles are coming out of diffuser plate, then check 1) tank is turned on and regulator is open and 2) all tubing connections. Apply SNOOP (or soapy water) to the tube connections and watch for bubbles, which indicate a gas leak.
 - b) Pump: If the pump is not working or is not working correctly:
 - i) Check battery charge and try another battery. It is always a good precaution to bring an extra battery with you to the field with you even if it is not fully charged. If changing the battery changes the pump rate, it is a battery problem. If changing the battery doesn't affect the rate, check to make sure all wires are well connected.
 - ii) Ensure pump thumbscrews are securely tightened.
 - iii) Refer to pump user's manual.

9.7 Sample Preservation

- 1) Gas Samples:
Cover the needle holes on the gas vials with silicon. This helps to keep gas from leaking out during storage. **VERY IMPORTANT:** Gas samples should not be warmed, (i.e., room temperature is fine), and away from a light and heat source, such as in a cooler.
- 2) Chloride Samples:
There are no preservation requirements for chloride samples.

9.8 Sample Shipping

- 1) Gas Samples
 - a) Ground ship samples within 7 days to gas analysis laboratory. Changes in temperature and elevation can alter the gas pressure in the gas vials. Samples should be shipped in a watertight container and placed in a cooler with icepacks.
- 2) Conservative Tracer Samples
 - a) Ship, within 7 days, the injectate sample and the 20 plateau conservative tracer sample bottles for (Cl⁻) analysis. Cl⁻ samples can be shipped at ambient temperature.
 - i) Fill out the Analysis Service Request (ASR) forms for the lab (Appendix B). Each Cl sample requires its own form. You will have a total of 21 forms, including the injectate sample, sample ID 0.

Title: AOS Protocol and Procedure: Reaeration Measuring Diffusion of O ₂ across the Water-Air Interface		Date: 04/23/2014
NEON Doc. #: NEON.DOC.000693	Author: K. Goodman	Revision: B

- ii) Make sure to note what the expected concentration of the injectate is in the “comments to NWQL” section; they will need to dilute the sample before analysis. The expected concentration can be taken from the injection spreadsheet used to calculate the concentration and injection rate of the conservative tracer (Figure 2).

9.9 Data Handling

1) Calculations

- a) Discharge: Discharge can be calculated from the conductivity measurements at Station 1 and Station 4.
 - i) Background-correct conductivity measurements at Station 1 and Station 4.
 - ii) Calculate Discharge as: (a) $Q = (C_{\text{salt}} * Q_{\text{salt}}) / C_{\text{station}}$, Where C_{salt} is the conservative tracer concentration (Cl⁻) in the injection solution, Q_{salt} is the injection rate (in L/s) and C_{station} is the background-corrected conservative tracer concentration at the Station 4.
 - iii) Station concentration can be calculated from conductivity measurements where 1 μS/cm = 0.5 ppm Cl⁻ (mg Cl⁻/L).
- b) Reach Velocity: Calculate Average Velocity of the Reach: $V = X / \text{Travel Time}$, Where X is the distance between Station 1 and Station 4, and Travel Time is the time it takes from to reach ½ half height at Station 4 minus the time to reach ½ height at Station 1.
- c) Reaeration Coefficient
 - i) Plot the natural log (LN) of the RATIO of the tracer gas concentration (or GC peak area) to the background-corrected Cl concentration (Y-axis) by Stream Distance (X-axis).
 - ii) The slope of the line is the SF₆ loss rate (m⁻¹).
 - iii) Calculate Reaeration Coefficient for SF₆: Multiply SF₆ loss rate by the reach velocity (m min⁻¹) to get reaeration rate coefficient for SF₆ (K_{SF_6} ; min⁻¹). Reach velocity is the distance between station 1 and 4 divided by the difference in timing of the maximum slope of the conservative tracer ascending limb at station 1 and 4.
 - iv) Convert Reaeration Coefficient for SF₆ to O₂ ($K_{\text{O}_2} = K_{\text{SF}_6} * 1.34$).
 - v) Convert K₂ values from ambient stream Temp to standard temperature (T=20C)
 - 1. $K_2(T=20C) = K_2(T) * (1.0241)^{(20 - (\text{Upstream}(T) + \text{Downstream}(T)/2))}$

2) Develop a relationship between discharge and K_{O_2} .

3) Enter data into excel file named “Reaeration Field Data.” Save file in format:

Reaeration_SITE_YYYYMMDD.xls

Station ID will be 1 (top of reaeration sampling reach) or 4 (bottom of reaeration sampling reach)

4) Stop conductivity probes from logging and download conductivity probe data. Save files as:

Reaeration Conductivity Data_SITE_StationID_YYYYMMDD

Station ID will be 1 (top of reaeration sampling reach) or 4 (bottom of reaeration sampling reach)

9.10 Refreshing the Sampling Kit

Restock the sampling kit (shipping coolers) with newly evacuated gas vials, new chloride sampling bottles (with new labels), syringe filters, needles, etc.

Title: AOS Protocol and Procedure: Reaeration Measuring Diffusion of O2 across the Water-Air Interface		Date: 04/23/2014
NEON Doc. #: NEON.DOC.000693	Author: K. Goodman	Revision: B

9.11 Equipment Maintenance, Cleaning, and Storage

- 1) Pump:
 - a) Run clean water (this can be stream water) through the pump and tubing for 20-30 minutes to rinse salt water from equipment. You can do this while you complete sample processing.
 - b) Rinse of external parts of the pump with freshwater to remove any salt solution.
 - c) Upon returning to Domain support facility remove pump head and piston from pump. Remove piston from drive carrier cylinder, and rinse off any remaining salt of the piston. Allow all parts to air dry before storing pump in a protected case.
 - i) Wrap piston in packing material to protect from breakage during storage.
 - ii) When reassembling pump drive and pump head, refer to section 9.5 Preparation for proper care
 - d) Empty all water from tubing before storage.
 - e) Lubricate pump prior to use by placing a small dab of high-grade machine oil on the piston drive pin immediately before inserting into the radial bearing (Figure 1b).
 - f) Place clean and dried pump in plastic storage bag, before placing in plastic storage tote with foam.
- 2) Charge batteries.

10 REFERENCES

Cole, J.J. and N.F. Caraco. 1998. Atmospheric exchange of carbon dioxide in a low wind oligotrophic lake. *Limnology and Oceanography* **43**:647-656.

FMI “Q” Pump Instructions. <http://fluidmetering.com/pdf/IN-Q431-09-A.pdf>

Hall, R.O. and J.L. Tank. 2003. Ecosystem metabolism controls nitrogen uptake in streams in Grand Teton National Park, Wyoming. *Limnology and Oceanography* **48(3)**:1120-1128.

Hubbard, E.F., F.A. Kilpatrick, L.A. Martens and J.F. Wilson, Jr. 1982. Measurement of time of travel and dispersion in streams by dye tracing: U.S. Geological Survey Techniques of Water-Resources Investigations, book 3, chap. A9, 44 p. United States Government Printing Office, Washington.

Hudson, F. 2004. Standard operating procedure—Sample preparation and calculations for dissolved gas analysis in water samples using a GC headspace equilibration technique. U.S. Environmental Protection Agency, RSKSOP-175, Revision No. 2. <http://www.epa.gov/ne/into/testmethods/pdfs/RSKsop175v2.pdf>. Accessed 16 March 2010.

Jahne, B., K.O. Munnich, R. Bosinger, A. Dutzi, W. Huber and P. Libner. 1987. On parameters influencing air-water gas exchange. *J. Geophys Res.* **74**: 456-464.

Kilpatrick, F.A. and E.D. Cobb. 1985. Measurement of discharge using tracers: U.S. Geological Survey Techniques of Water-Resources Investigations, book 3, chap. A16, 52 p. United States Government Printing Office, Washington.

<i>Title:</i> AOS Protocol and Procedure: Reaeration Measuring Diffusion of O2 across the Water-Air Interface		<i>Date:</i> 04/23/2014
<i>NEON Doc. #:</i> NEON.DOC.000693	<i>Author:</i> K. Goodman	<i>Revision:</i> B

Kilpatrick, F.A., and J.F. Wilson, Jr. 1989. Measurement of time of travel in streams by dye tracing: U.S. Geological Survey Techniques of Water-Resources Investigations, book 3, chap. A9, 27 p. United States Government Printing Office, Washington.

Kilpatrick, F. A., R. E. Rathbun, N. Yotsukura, G. W. Parker and L. L. DeLong. 1989. Determination of stream reaeration coefficients by use of tracers, book 3. Chap A18, Techniques of Water Resources Investigations of the U.S. Geological Survey, Denver, CO. United States Government Printing Office, Washington.

Kilpatrick, F.A. 1993. Simulation of soluble waste transport and buildup in surface waters using tracers: U.S. Geological Survey Techniques of Water-Resources Investigations, book 3, chap. A20, 37 p. United States Government Printing Office, Washington.

Raymond, P.A., C.J. Zappa, D. Butman, T.J. Bott, J. Potter, P. Mulholland, A.E. Laursen, W.H. McDowell and D. Newbold. 2012. Scaling the gas transfer velocity and hydraulic geometry in streams and small rivers. *Limnology and Oceanography: Fluids & Environments* **2**:41-53. DOI 10.1215/21573689-1597669

Senior, L.A., and M.C. Gyves. 2010. Determination of time-of-travel, dispersion characteristics, and oxygen reaeration coefficients during low stream flows—Lower Tacony/Frankford Creek, Philadelphia, Pennsylvania: U.S. Geological Survey Scientific Investigations Report 2010-5195, 90 p. United States Government Printing Office, Washington.

Tobias, C.R., J.K. Bohlke, and J.W. Harvey. 2009. A simple technique for continuous measurement of time-variable gas transfer in surface waters. *Limnology and Oceanography: Methods* **7**:185-195.

Wanninkhof, R. 1992. Relationship between wind speed and gas exchange over the ocean. *Journal of Geophysical Research* **97**: 7373-7382.

<i>Title:</i> AOS Protocol and Procedure: Reaeration Measuring Diffusion of O2 across the Water-Air Interface		<i>Date:</i> 04/23/2014
<i>NEON Doc. #:</i> NEON.DOC.000693	<i>Author:</i> K. Goodman	<i>Revision:</i> B

APPENDIX A FIELD DATA SHEETS

The following field data sheets serve as a backup procedure for times when electronic data collection devices (PDA) are not available.

Title: AOS Protocol and Procedure: Reaeration Measuring Diffusion of O2 across the Water-Air Interface		Date: 04/23/2014
NEON Doc. #: NEON.DOC.000693	Author: K. Goodman	Revision: B

Reaeration Field Data Sheets

Protocol revision: _____

BACKGROUND CONDUCTIVITY VALUES

Site ID (4 or 7 letter code): _____

Date (YYYYMMDD): _____ Time (24:00, local time): _____

Technician 1 ID: _____ Technician 2 ID: _____

Be sure to take conductivity readings across main flow of water.

Background (Pre-Injection) Conductivity (uS/cm @25C)

Station #	Measurement 1	Measurement 2	Measurement 3	Measurement 4	Notes
1					
2					
3					
4					

Title: AOS Protocol and Procedure: Reaeration Measuring Diffusion of O2 across the Water-Air Interface		Date: 04/23/2014
NEON Doc. #: NEON.DOC.000693	Author: K. Goodman	Revision: B

Date (YYYYMMDD): _____ **Site ID:** _____
Amt. Salt Added (g): _____ **Carboy Total Volume (units):** _____
Drip Start Time: _____ **Drip End Time:** _____ **Tech IDs** _____
Drip Rate Start (ml/min): _____ **Drip Rate End:** _____ **Gas Type:** _____

Station ID	Distance from Injection (m)	Time	Water Temp (°C)	Conductivity (uS/cm @25C)	Syringe ID	Vacutainer ID	Bottle ID	Notes
Injectate								
1								
1								
1								
1								
1								
2								
2								
2								
2								
2								
3								
3								
3								
3								
3								
4								
4								
4								
4								
4								

Be sure to take conductivity readings in main flow of water.
 Sample at Plateau: 45 mL water equilibrated with 15 mL air
 Grey cells remain blank.

Title: AOS Protocol and Procedure: Reaeration Measuring Diffusion of O2 across the Water-Air Interface		Date: 04/23/2014
NEON Doc. #: NEON.DOC.000693	Author: K. Goodman	Revision: B

Site ID: _____

Date: _____

Technician 1 ID: _____

Technician 2 ID: _____

Replicate #	Stream Wetted Width (m)
1	
2	
3	
4	
5	
6	
7	
8	
9	
10	
11	
12	
13	
14	
15	
16	
17	
18	
19	
20	
21	
22	
23	
24	
25	
26	
27	
28	
29	
30	

Take 30 stream width measurements between reaeration site 1 and site 4, after injection is completed.

<i>Title:</i> AOS Protocol and Procedure: Reaeration Measuring Diffusion of O2 across the Water-Air Interface		<i>Date:</i> 04/23/2014
<i>NEON Doc. #:</i> NEON.DOC.000693	<i>Author:</i> K. Goodman	<i>Revision:</i> B

APPENDIX B LAB DATA SHEETS

The following data sheets serve as a backup procedure for times when electronic data collection devices (PDA) are not available.

Title: AOS Protocol and Procedure: Reaeration Measuring Diffusion of O2 across the Water-Air Interface		Date: 04/23/2014
NEON Doc. #: NEON.DOC.000693	Author: K. Goodman	Revision: B

APPENDIX C CONSIDERATIONS FOR IMPLEMENTATION

Exposing gas vials to heat should be avoided as increases in temperature can influence gas vial storage and increase the risk of gas lost. Changes in pressure (e.g. elevation changes) can increase the risk of gas lost and samples should be shipped ground.

It is extremely important that good travel time estimates be calculated. This should be easy to do during NEON Operations, as there will be sensors installed at Station 1 and Station 2. However, during Construction, thorough conductivity measurements should be recorded manually to estimate travel time.

Ensure conservative tracer reservoir does not run dry. Adjust pump rate to ensure reservoir is not depleted prior to reaching plateau and sampling. Pump rate should also be measured at the start and just before stopping the injection, if not multiple times during the injection.

Extremely saturated salt solution can clog the filter in the filter housing and influence the pump rate.

Try to keep salt solutions to <50% NaCl.

Samples must be processed away from stream to avoid contamination. Common errors include:

- 1) Sampling from downstream (Station 4) to upstream (Station 1), rather than the appropriate upstream to downstream sampling. Imagine that you are sampling from upstream to downstream so that you can sample the same parcel of water as it moves in the downstream direction.
- 2) Not sampling in thalweg.
- 3) Forgetting to shake syringes prior to gas sampling.